



Stevenson Road , Coventry, CV6 2JU Offers over £175,000

Evans Estates is delighted to present this charming two-bedroom end of terrace house, perfectly suited for first-time buyers. Located on Stevenson Road in the desirable Keresley area of Coventry, this property offers a wonderful opportunity to create a comfortable home.

Upon entering, you are welcomed by an inviting entrance hall that leads into a spacious through lounge diner, ideal for both relaxation and entertaining. The extended kitchen provides ample space for culinary pursuits, while the lean-to offers additional versatility for storage or utility needs.

On the first floor, you will find two well-proportioned bedrooms, providing a peaceful retreat for rest and relaxation. The bathroom is conveniently located to serve both bedrooms. For those seeking extra space, the second floor features stairs leading to a boarded loft area, which could be transformed into a study, playroom, or additional storage.

The property benefits from double glazing and gas central heating, ensuring comfort throughout the seasons. Externally, there is a hard standing area to the front, perfect for off-road parking, and a lovely garden to the rear, offering a private outdoor space for

- Ideal First Time
- End of Terrace
- Through Lounge Diner
- Boarded Loft Space

Viewing

Please contact our Evans Estates Office on 02476333363 if you wish to arrange a viewing appointment for this property or require further information.



2



1



1



Floor Plan

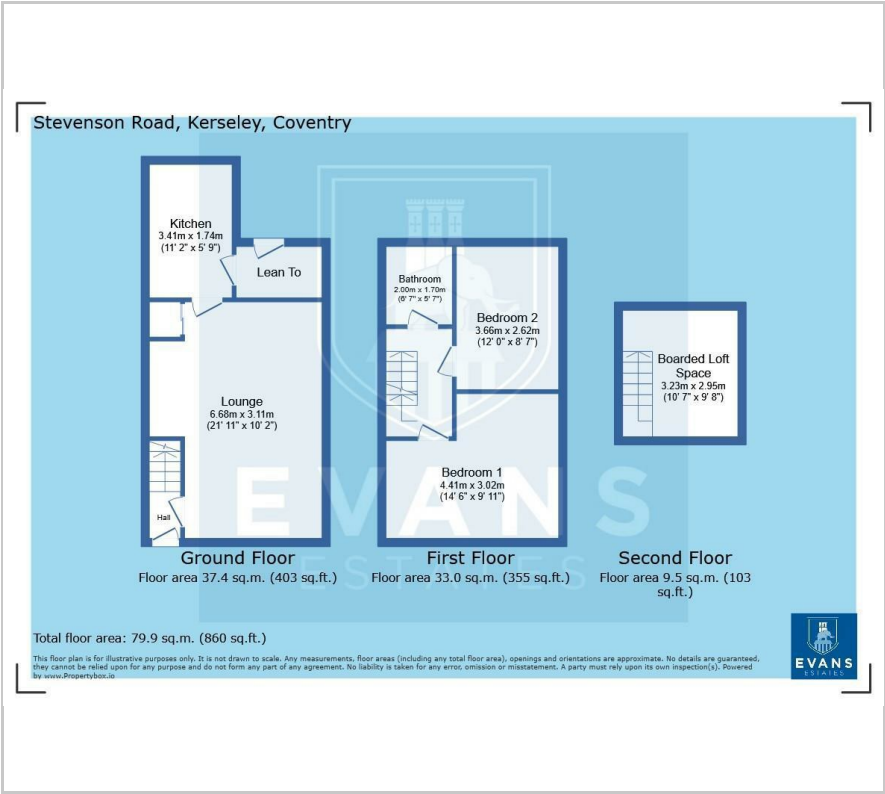

Area Map



Energy Efficiency Graph



These particulars, whilst believed to be accurate are set out as a general outline only for guidance and do not constitute any part of an offer or contract. Intending purchasers should not rely on them as statements of representation of fact, but must satisfy themselves by inspection or otherwise as to their accuracy. No person in this firms employment has the authority to make or give any representation or warranty in respect of the property.